

0 Bar heat an



1. Attention of overheating

Reason

Defend the following matter about overheating. Important injury might be received if it doesn't guard and it is dangerous.



1.

Attention

of

overheating

注意 Do not open the hood until steam doesn't occur when it overheats, and steam has occurred from the bonnet.



- Important injury such as the burns might be received because the high temperature in the engine room and it is dangerous. Moreover, note that there is a part that is the high temperature even when steam has not occurred enough when opening the hood.

注意 Do not open the radiator cap air pulling out valve when the radiator and the auxiliary tank are hot. (Refer to P.485.)

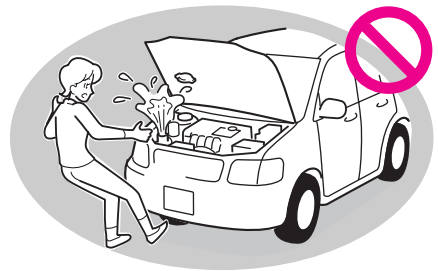

- Steam and the hot water spout, important injury such as the burns might be received, and it is dangerous. - The cloth cutting etc. , wrapping of the cap valve after it gets cold, and open it slowly as the radiator the auxiliary tank is enough when you open the cap valve.



2. Attention at emergency accident

Defend the following matter. It might cause an unexpected accident and serious injury if it doesn't guard and is dangerous.



滴 Note the steering wheel and the brake operation enough when it is pulled as the engine doesn't start.

- The operation power becomes very heavy because neither the power steering nor the brake twice power device work if it doesn't engine starts. Note driving the pulled car enough.

滴 Do not drive while pulling it as a big impact joins the pulling hook and the rope like the jack rabbit start etc.

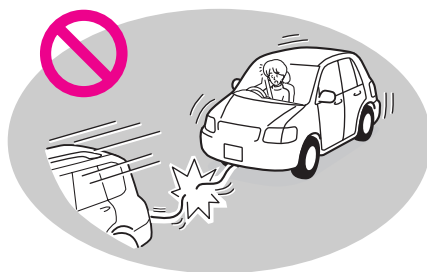

- The pulling hook and the rope are damaged, it hits a surrounding person etc. , important injury might be given, and it is dangerous.

滴 Do not pull out the key from the engine switch while pulling it, and do not make the engine switch LOCK.

- It becomes impossible to do the steering wheel control it, is locked the steering wheel when the key has come off, might cause an unexpected accident, and is dangerous. Moreover, the key might come off when the engine switch is LOCK.



注意 Do not use Tahonootsts near the combustible such as the fuels. Moreover, do not turn to the face and the body, and do not bring it close while using Tahonootsts.



- It might ignite if it uses it near the combustible and is dangerous. Moreover, important injury might be received and it is dangerous of doing etc. ..combustion by the flame.. as turning to the face and the body while using it.

注意 Confirm whether the fuel has leaked before starting the engine after the accident.

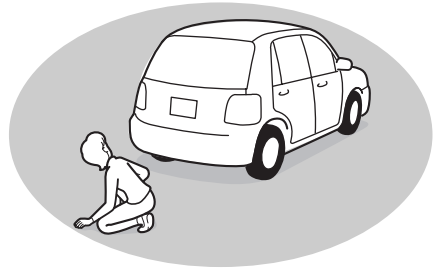

- There is a possibility that the fuel system has been damaged if the road under the car etc. are confirmed, and the leakage of the liquid (Excluding the water of the air conditioner) is found. It ignites to the fuel if the engine is started as it is, it might cause a serious accident, it is not dangerous, and do not start the engine.

In this case, tell it also at the report of the situation to the Toyota shop.

Warning

2. Hybrid

Overheat because

of Cot drinking

Other attention



Defend the following matter.
In the worst case, it reaches an unexpected accident and serious injury if it doesn't guard or, it is likely to lead to the death.



Warning

Other

attention

滴 Never do an illegal remodeling.

- If the one other than parts that Toyota reported to the Ministry of Land, Infrastructure and Transport are installed, it is likely to become an illegal remodeling. -

Height is dropped, it causes the breakdown when an unsuitable parts to the performance and the function of the car as a wide tire is installed are installed, and the accident is caused, important injury might be received, and it is dangerous. -

Never remodel the steering wheel. It doesn't operate normally, and it swells by mistake, and it reaches important injury or, in the worst case, it is likely to lead to the death when inadequately treating because the SRS air bag is built into the steering wheel. -

In the following cases, consult the Toyota shop.

蘆 Exchange of tire disc wheel wheel installation nuts.

If the one other than the different species and specification are used, the adverse effect might be caused for running, and it become an illegal remodeling.

蘆 Installations such as electrical equipments and wireless machines and detaching.

The adverse effect is caused for an electronic equipment parts, and it might cause the accident like the breakdown and a vehicle fire, etc. and is dangerous.

滴 Surely erase the match and the burning cigarette end, and close after using a movable ashtray.

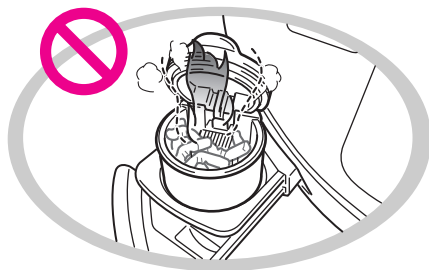

- It might connect with a vehicle fire when leaving it while opened and is dangerous. Moreover, do not put the combustible one such as wastepapers in the ashtray.

! Other attention

澆 Do not put the one other than the cup and the beverage can in the cup holder.

- What stored when time that slammed on the brakes and colliding dashes out, and it is likely to injure. Moreover, close when you do not use it.

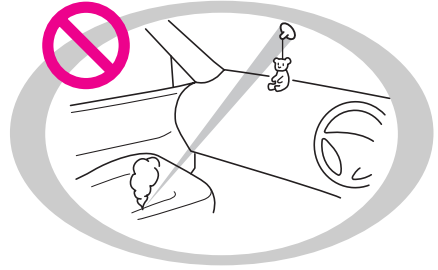

澆 Do not apply the sucker to the window glass etc.

- It works the lens by the sucker, might connect with a vehicle fire, and is dangerous.



潛 Never take the person in the luggage room.

- It flies the body when time that slammed on the brakes and colliding, and it reaches important injury or, in the worst case, it is likely to lead to the death.

注意 Do not place other people's hands etc. when you close the backing door. Moreover, do not let the child operate the backing door.

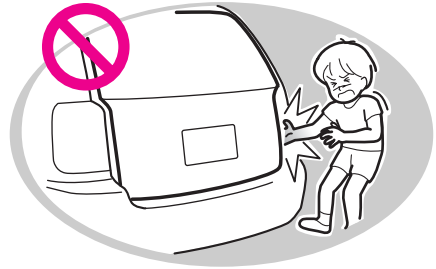

- In the worst case, it reaches important injury or, it is likely to lead to the death by placing the hand, the head, and the neck, etc. when closing when the child operates it. -

Close the backing door pushing from the outside without fail. When the backing door is closed directly in the backing door grip, the hand and the arm are placed, and important injury might be received and it is dangerous. -

Do not close the backing door, and do not hang with Baccdoadamparsta.

It might cause an unexpected accident by placing the hand, and shifting when Damparsta is damaged and is dangerous.

注意 Confirm the light shake of the backing door before it runs, and the lock surely.

- It opens suddenly while running if the backing door is not surely closed the backing door, might cause an unexpected accident, and is dangerous. -

Do not run with the backing door opened. It hits the one outside the car etc.

by the backing door if running while opened, might cause an unexpected accident, and is dangerous.

注意 Consult the Toyota shop when you exchange Dischargeheddoramp (Include the lamp exchange). (Dischargeheddoramp installation car)

- When the lighting operation is done with it touched the lamp socket, momentarily a high voltage of 20,000V is generated, and it is likely to get an electric shock.

注意 The surface of the door mirror doesn't become hot while the mirror heater of the mirror heater installation car is operating, and do not touch it.

- The burn might be done and it is dangerous.



Warning

Other

attention

! Other attention

潜The lower side of the glass doesn't become hot while operating the reception desk window shield glass with heat ray, and do not touch it. (reception desk window shield glass installation car with heat ray)

- The burn might be done and it is dangerous.

潭Note that detached neither battery nor parts (Especially, the child :) are swallowed when the batteries of the wireless door lock remote control smart key are exchanged.

- Important injury might be received when swallowing and it is dangerous.

激The electric wave might exert the influence on the equipment for the medical treatment of the heart pacer etc. , and confirm the person who takes the smart door lock installation car to an electric equipment manufacturers for the medical treatment etc. beforehand.

撞Accessories fixed with the magnet cannot be installed in the aluminum body.

- Because the magnet doesn't attach to aluminum, the beginner driving sign and the senior citizen driving sign etc. of the magnet type cannot be installed.

潘Do not spill the drink etc. in the switch in the car etc.

- It causes the breakdown, and when the drink splashes to switches etc. that the Instrument panel, the console box, and the door, etc. include, it might connect with a vehicle fire and is dangerous. Consult the Toyota shop promptly when the drink splashes to the switch by any chance.

⚠ Do not touch the muffler engine starts or immediately after the stop of the engine.

- The muffler immediately after time that engines starts and the stop of the engine is a high temperature. When the hand and the foot touch at the time of unloading luggage etc. , the burn might be done. Do after it cools enough when you touch the exhaust tube by the check etc.



Warning

Other

attention

! Other attention

MEMO



Other

attention